

# Tallaabo-tallaabo ku saabsan sida loo Isticmaalo Canvas

1. Isticmaal Google Chrome maadaama uu yahay baroowsarka ugu haboon ee loo isticmaali karo Canvas.
2. Booqo [www.google.com](http://www.google.com) kadibna qaybta baarista ku qor: Canvas.

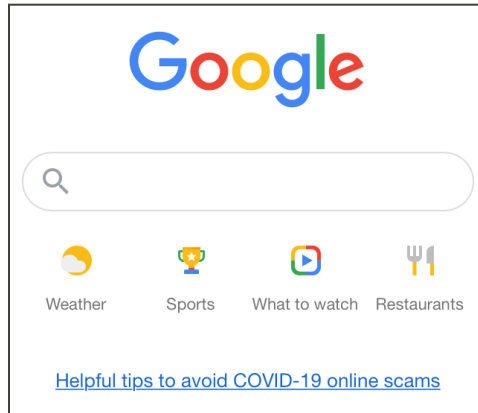

3. Isticmaal lifaaqa ay ku qoran tahay "Canvas by Instructure (Tillaamaha Canvas)."

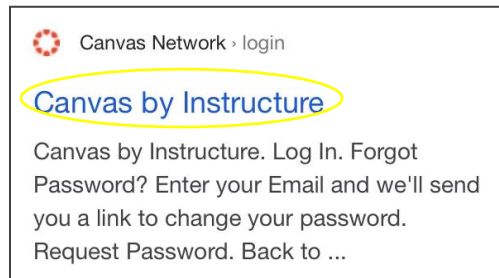

4. Geli iimaylkaaga iyo baasaweerkaaga, kadibna dooro: Log in (Gal barta).

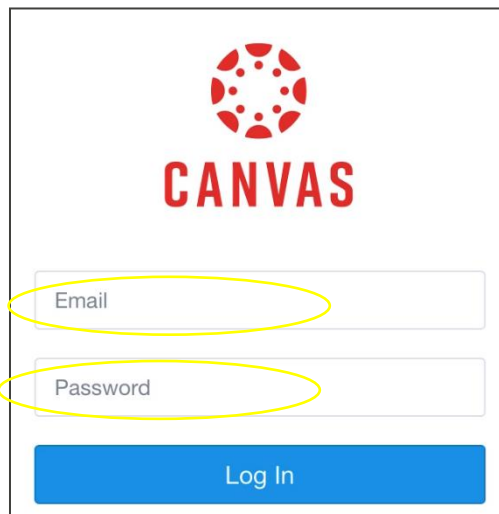

5. Waxaad u gudbaysaa Dashboard (Qaybta koowaad).



6. Si aad u hesho Koodhka Waalidka si aad barta usoo gasho adoo ah Kormeeraha shaqada ilmahaaga, booqo:

a) Dooro: Account (Akoonka).



b) Dooro: Settings (Siting).



c) Dooro: Pair with Observer (qayb noqo Kormeeraha).



d) Seyf garee **KOODHKA LA FALGELIDA ARDAYGA.**

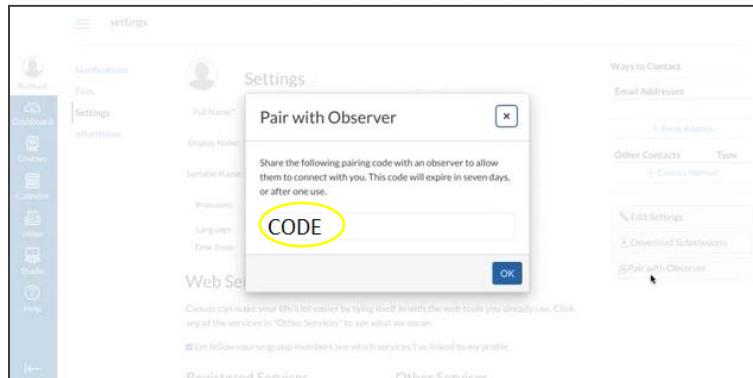

**ABUUR AKOON CANVAS AH OO AAD WAALID AHAAN U ISTICMAASHO:** Isticmaalida ablikeeshinka Waalidka ee Canvas waxaa maamulka dugsiga ardayga. Waxaad u baahan doontaa URL-ka barta Canvas ee la xariira dugsiga uu ardaygaagu ka diiwaangashan yahay. La xariir dugsiga si aad u hesho URL-ka Canvas.

Parent Signup (Gelida Barta ee Waalidka):

1. Geli macluumaadkaaga. Isticmaal **KOODHKA LA FALGELIDA ARDAYGA** ee horey lagu siiyay, kadibna u gudub qaybta "START PARTICIPATING (BILLOOW KA QAYBQAADASHADA)."

A screenshot of the 'Parent Signup' form. The title 'Parent Signup' is circled in yellow. The form contains several input fields: 'Your Name', 'Your Email', 'Password', 'Re-enter Password', and 'Student Pairing Code'. There is a blue link 'What is a pairing code?' next to the 'Student Pairing Code' field.

2. Gal barta sida adoo ah Waalid/Kormeere: Geli iimaylkaaga iyo Baasaweerkaaga.

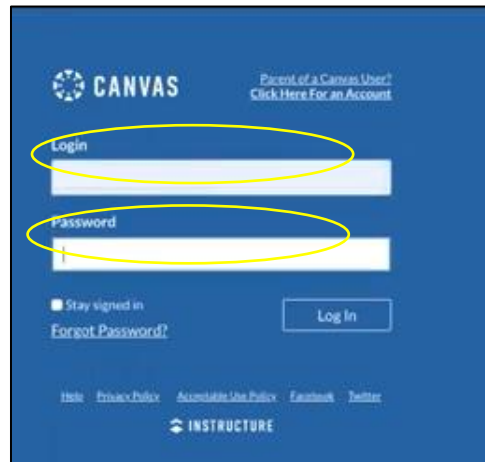

3. Waxaa lagu guddbinayaa qaybta koowaad ee bogga ardaygaaga adoo ah Kormeere.

